

Item Report - 578XX334 (Bill of Material)

User	Component	Qty per	Stk UM	Description
0001	578XX015	1.000	EA	SPRING SUPPORT, V75-4
0002	578XX019	1.000	EA	SPRING CLAMP, 4 IN.
0003	578XX021	2.000	EA	PRIMARY SPRING, 2X8
0004	578XX022	2.000	EA	SECONDARY SPRING 2X2
0005	798XX109	4.000	EA	SHCS 1/4-20 X 5/8 SS
0006	798XX697	2.000	EA	NUT,HEX 1/2-13 ZINC
0007	798XX766	2.000	EA	FLAT WASHER 1/2 ZINC

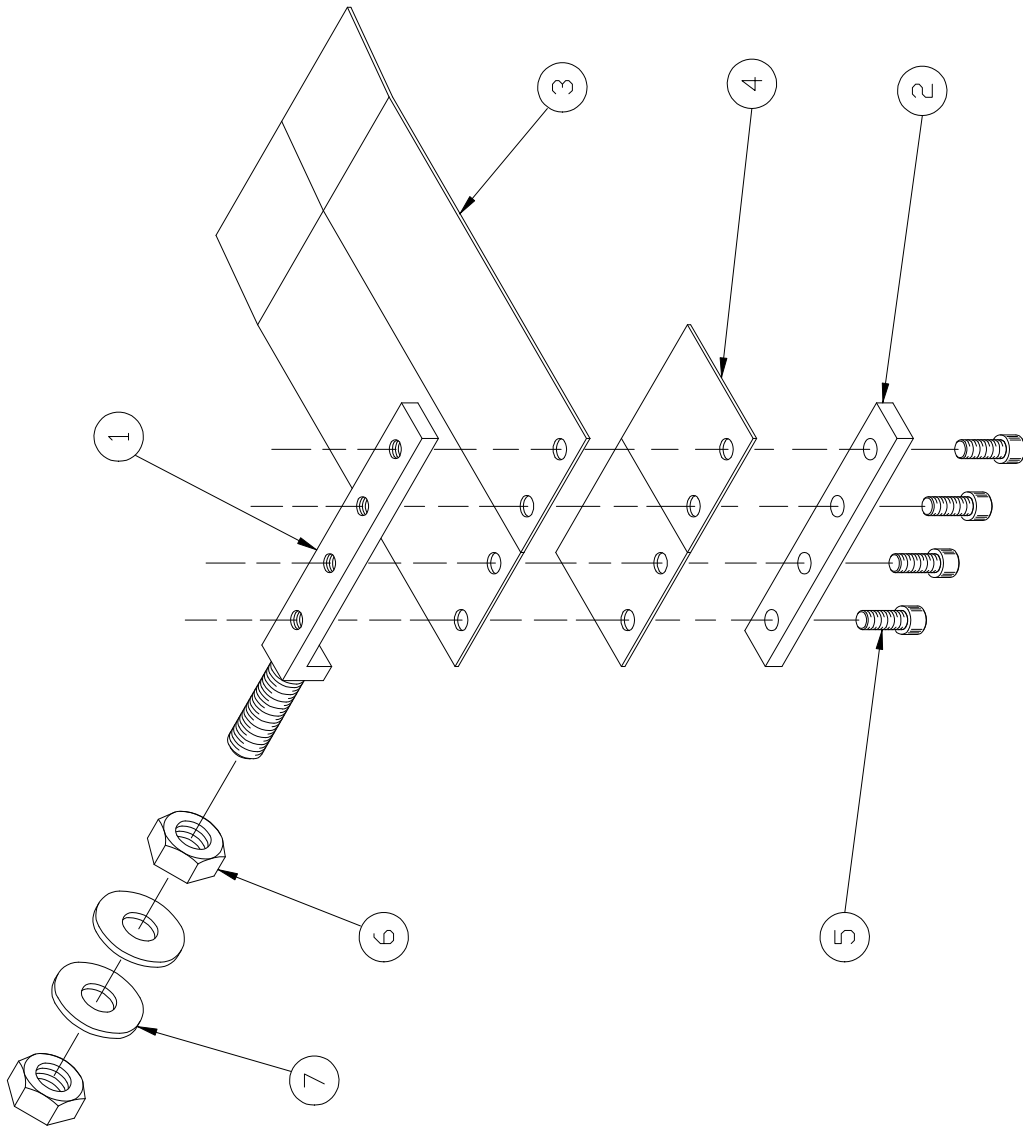

PROPERTY CONTAINING PROPRIETARY INFORMATION WHICH
BE REPRODUCED OR DISCLOSED WITHOUT WRITTEN VAL
PERMISSION AND MUST BE RETURNED UPON DEMAND.

VALCO CINCINNATI		TITLE 4" SPRING ASSEMBLY (L.H.)	
USED ON: -	TOLERANCES - EXCEPT AS NOTED	ANGULAR +/- 1 DEG.	DRAWING NUMBER 578XX334
MTL: -	FRACTIONAL +/- 1/64	MACHINED SURFACES 125	DATE 10-16-86
FINISH - OTHER: -	DECIMAL +/- .005	DRAWN BY K.R.	SCALE HALF
REV: (PUT INTO CAD) 10-16-86 R.D.	THREAD LENGTH DIMENSIONS ARE FULL THREAD HOLES TO BE CHAMFERED ONE THREAD DEPTH MAX UNLESS OTHERWISE SPECIFIED	CHECKED R.D.	SHEET 1 OF 1
	<input type="checkbox"/> CHECK IF REQD. DRY GLASS BEAD BLAST (AVOID THREADED AREAS) PLATE ELECTROLESS NICKEL .0003 THICK	APPROVED -	SUPERSEDES NEW
	<input type="checkbox"/> CHECK IF REQD. SATIN SCREEN CLEAR ANODIZE		
	BREAK ALL SHARP EDGES & CORNERS (REBURR) UNLESS OTHERWISE SPECIFIED (.015 MAX)		

Item Report - 578XX038 (Bill of Material)

User	Component	Qty per	Stk UM	Description
0001	578XX011	1.000	EA	BACKPLATE, V75
0002	578XX339	1.000	EA	HEAD SUPPORT; LONG
0003	578XX013	1.000	EA	PRODUCT GUIDE, STATIONARY
0004	578XX015	1.000	EA	SPRING SUPPORT, V75-4
0005	578XX019	1.000	EA	SPRING CLAMP, 4 IN.
0006	578XX021	2.000	EA	PRIMARY SPRING, 2X8
0007	578XX022	2.000	EA	SECONDARY SPRING 2X2
0008	566XX032	2.000	EA	SLIDER BAR 760-8BT-8
0009	798XX697	2.000	EA	NUT,HEX 1/2-13 ZINC
0010	798XX766	2.000	EA	FLAT WASHER 1/2 ZINC
0011	798XX872	2.000	EA	HHCS 1/4-20 X 3/8
0012	798XX735	2.000	EA	LOCK WASHER 1/4 ZINC
0013	798XX699	4.000	EA	NUT,FLANGE 1/2-13
0014	798XX109	4.000	EA	SHCS 1/4-20 X 5/8 SS
0015	798XX610	1.000	EA	HHCS 5/16-18 X 3/4
0016	798XX738	1.000	EA	LOCK WASHER 5/16
0017	578XX023	1.000	EA	COLLAR, STOP 1/2"

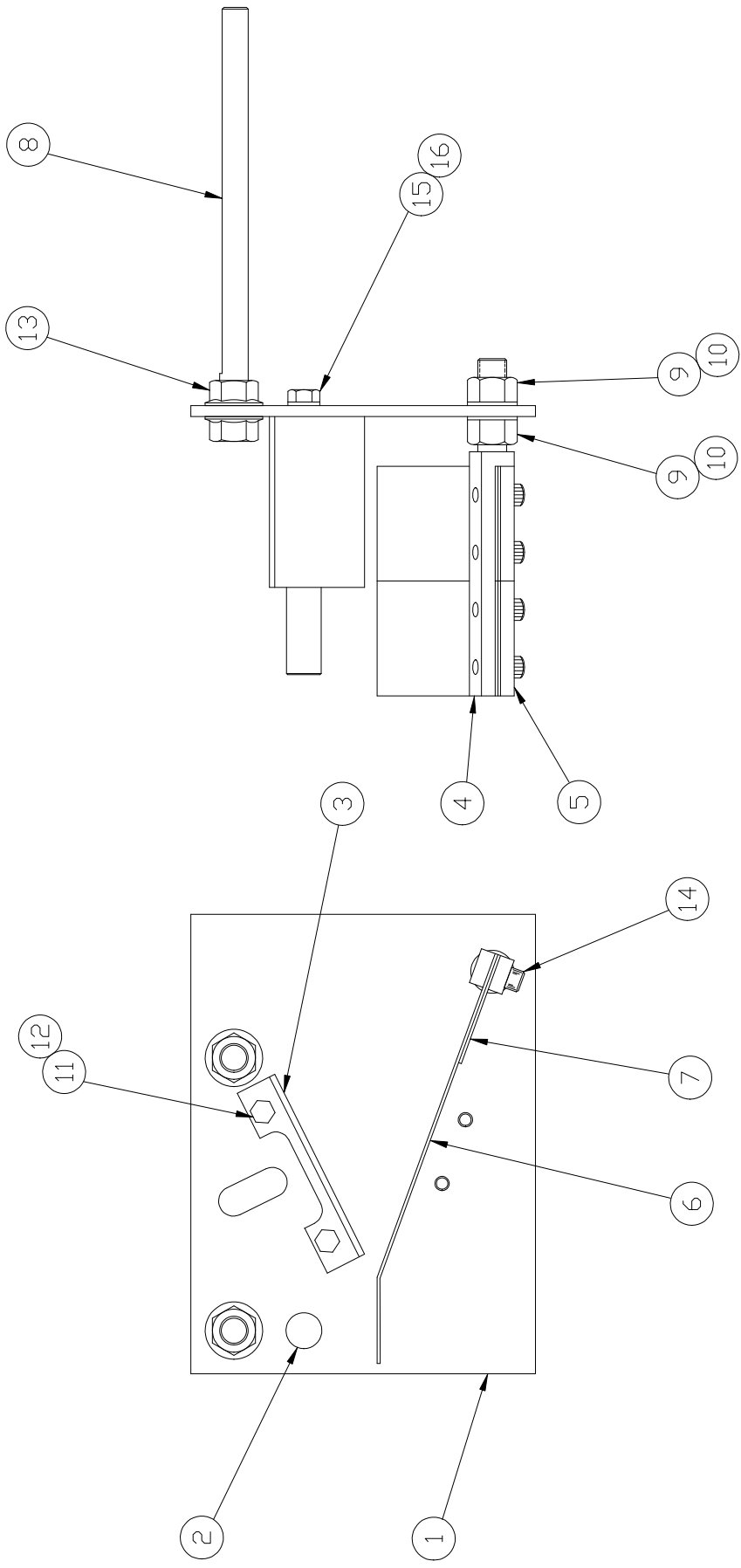

578XX038 - ASSEMBLED AS SHC
 578XX682 - MIRROR IMAGE

USED ON: - MTL: - FINISH - OTHER: - REV.: (PUT INTO CAD) 7-8-86 R.D. (A) UPDATED ITEM #1 6-27-90 K.R. 6-28-90 LTN (B) ADDED NEW ASS'Y. P/N, MODEL 6-3-91 K.R. 6-4-91 D.R.R.		CHECK IF REQ'D. DRY GLASS BEAD BLAST (AVOID THREADED AREAS) PLATE ELECTROLESS NICKEL .0008 THICK		TOLERANCES - EXCEPT AS NOTED FRACTIONAL +/- 1/64 DECIMAL +/- .005 ANGULAR +/- 1 DEG. MACHINED SURFACES 125/		VALCO CINCINNATI TITLE BRACKET ASS'Y. ONLY TOP DOWN (V-75-0-4 & V-75-L-4)	
CHECK IF REQ'D. SATIN SCREEN CLEAR ANODIZE		THREAD LENGTH DIMENSIONS ARE FULL THREAD HOLES TO BE CHAMFERED ONE THREAD DEPTH MAX UNLESS OTHERWISE SPECIFIED		DRAWN BY K.R. CHECKED R.D. APPROVED -		DATE 7-8-86 SCALE HALF SHEET 1 OF 1 SUPERSETES NEW DRAWING NUMBER 578XX038-	

PROPERTY CONTAINING PROPRIETARY INFORMATION WHICH
 BE REPRODUCED OR DISCLOSED WITHOUT WRITTEN VALCO
 PERMISSION AND MUST BE RETURNED UPON DEMAND.